

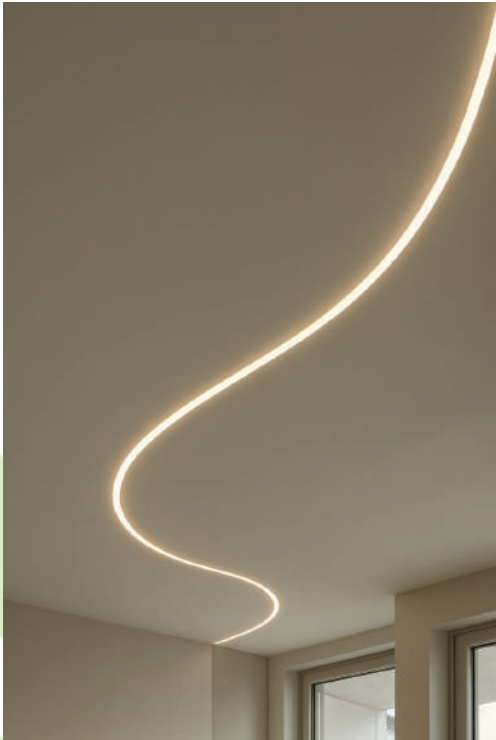

The Linora Curve is a high-performance linear lighting solution designed for modern architectural applications. Featuring a sleek 60mm x 60mm profile, this fixture blends style and functionality, offering flexible installation options including pendant, ceiling, recessed, or wall-mounted setups.

Delivering a consistent 100 lm/W efficiency, the Linora Curve supports a wide range of beam angles – PC: 105°, M1: 72°, M2: 70° – and optical variants (DF, M1, M2) to meet diverse lighting needs.

Choose from CCT ranges of 2700K to 6500K, including RGB color options, for dynamic or ambient lighting control. With CRI options >80, >90, and >95, it ensures accurate color rendering for professional environments.



### Technical Data

Lighting direction	Down
Installation	Pendant , Ceicling , Recessed , wall mounted
Beam angle	PC:105° , M1:72° , M2:70°
Light efficiency	100lm/W
Profile	W60mm*H60mm
Power	18 W/m
Optic	DF , M1 , M2
CCT	2700K / 3000K / 4000K / 6500K / RGB
DIMMING	NON , 0-10V , DALI
Input voltage	200-240V , 100-277V
CRI	>80 , >90 , >95
Warranty	5 Years

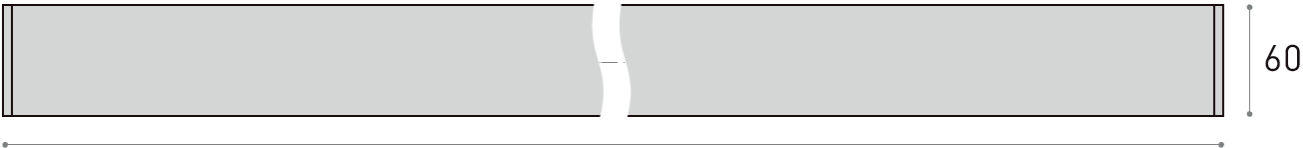

# Lamps Parameter

Length [mm]	Power [w]	Luminous [lm]
500	14	1400
600	16.8	1680
700	19.6	1960
800	22.4	2240
900	25.2	2520
1000	28	2800
1100	30.8	3080
1200	33.6	3360
1300	36.4	3640
1400	39.2	3920
1500	42	4200
1600	44.8	4480
1700	47.6	4760
1800	50.4	5040
1900	53.2	5320
2000	56	5600
2100	58.8	5880
2200	61.6	6160
2300	64.4	6440
2400	67.2	6720

## Colour More Custom Colors



## Profile Section

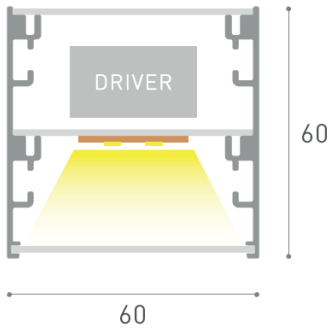

## Installation



## Installation-Profile connection

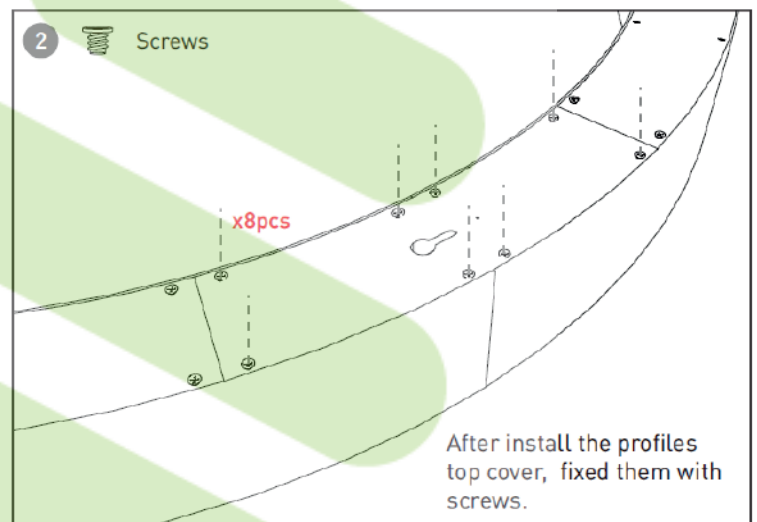
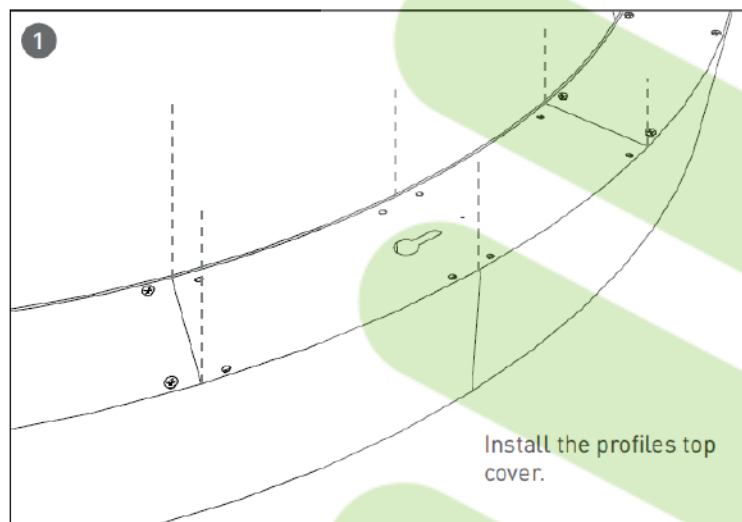
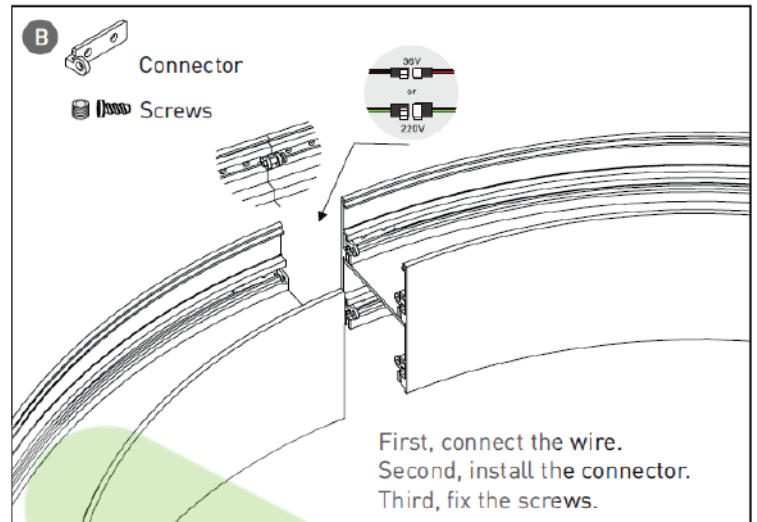
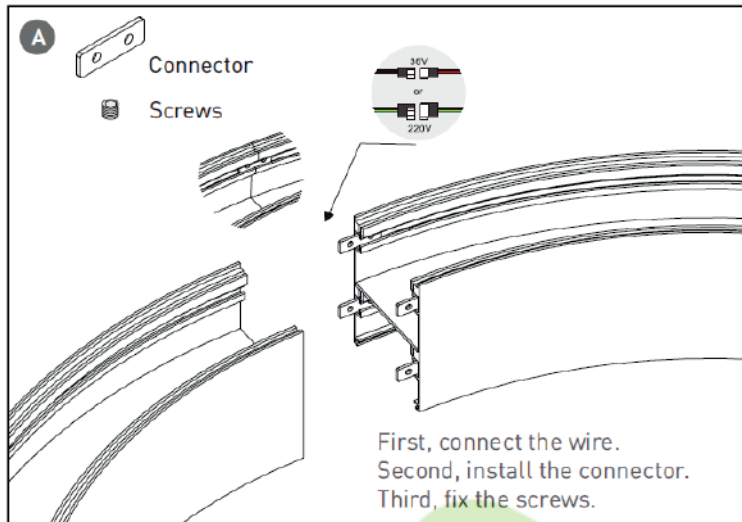

## Installation-Cover

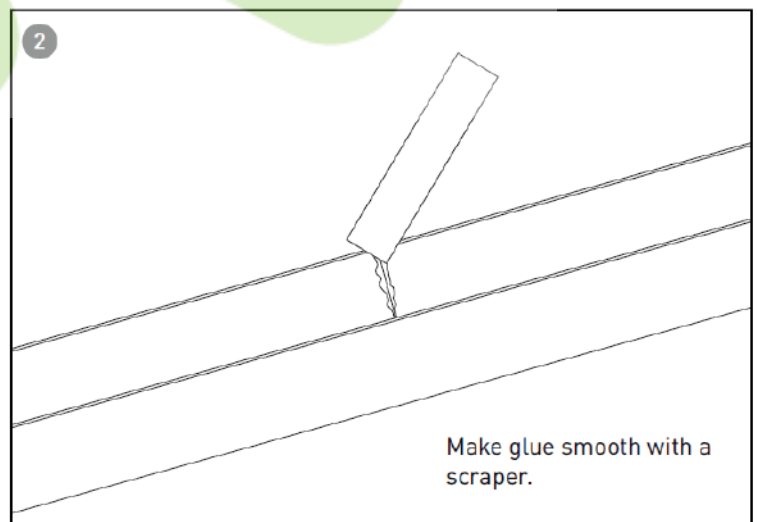
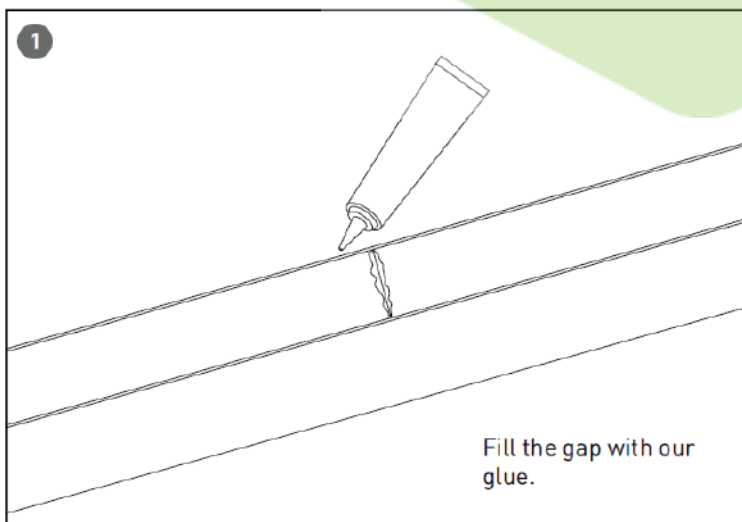

# Installation-End cap

